

AUBURN ITC BLDG E, STE 120

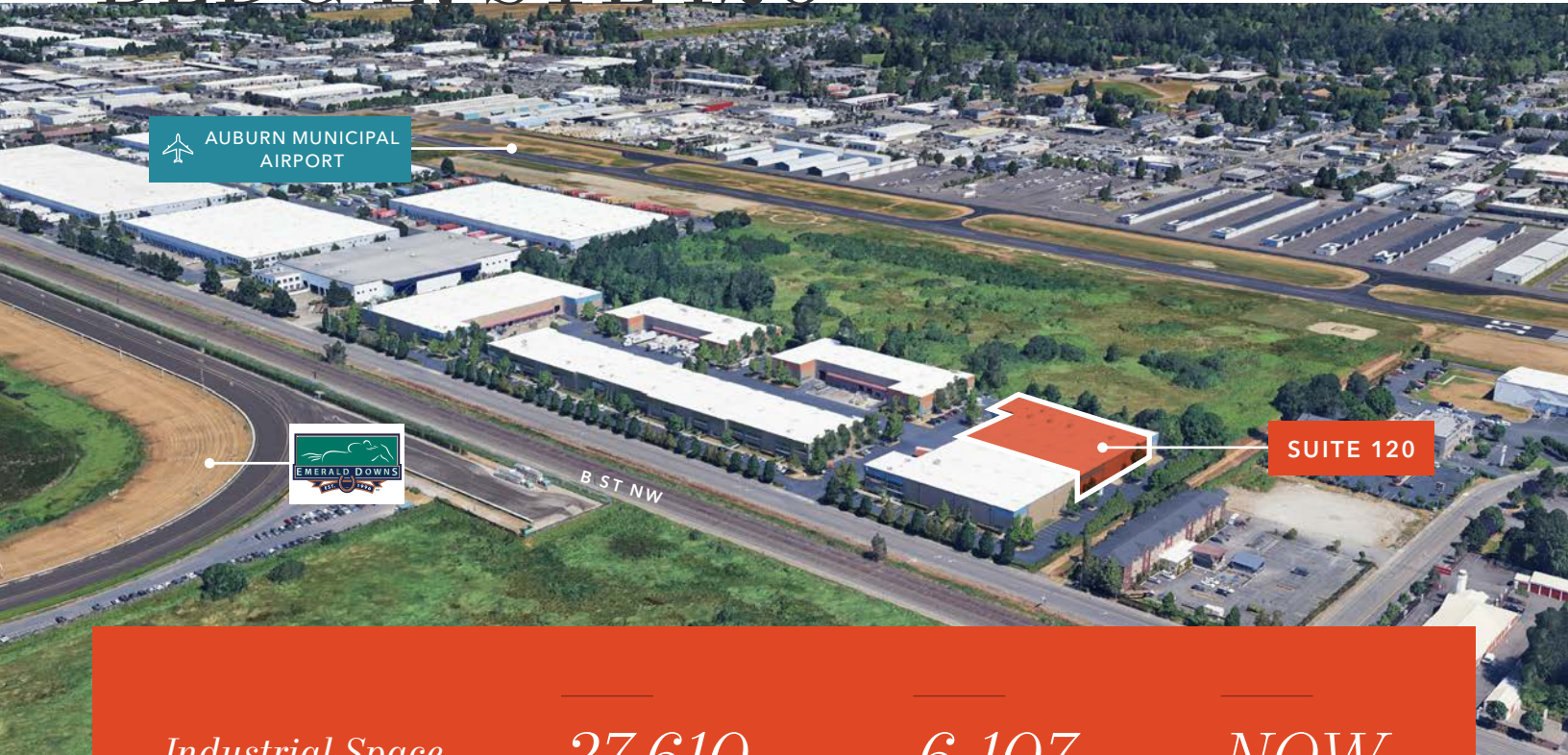

*Industrial Space
For Lease*

27,610
TOTAL SF

6,107
OFFICE SF

NOW
AVAILABLE

27,610 SF available

6,107 SF office

Easy access to SR-167 via 277th St or 15th St & access to I-5 via 277th St

Available now

6 DH / 1 GL doors, 24' clear height

M-1 zoning

Canopies over loading doors

\$1.20 shell rate, \$1.25 office rate

50' concrete aprons

CHRIS CORR
206.248.7324
chris.corr@kidder.com

MATT MURRAY, SIOR
206.248.6541
matt.murray@kidder.com

KIDDER.COM

This information supplied herein is from sources we deem reliable. It is provided without any representation, warranty, or guarantee, expressed or implied as to its accuracy. Prospective Buyer or Tenant should conduct an independent investigation and verification of all matters deemed to be material, including, but not limited to, statements of income and expenses. Consult your attorney, accountant, or other professional advisor.



27,610 SF

AVAILABLE

\$1.20

SHELL RATE

NOW

AVAILABLE

SUITE 120 FLOORPLAN

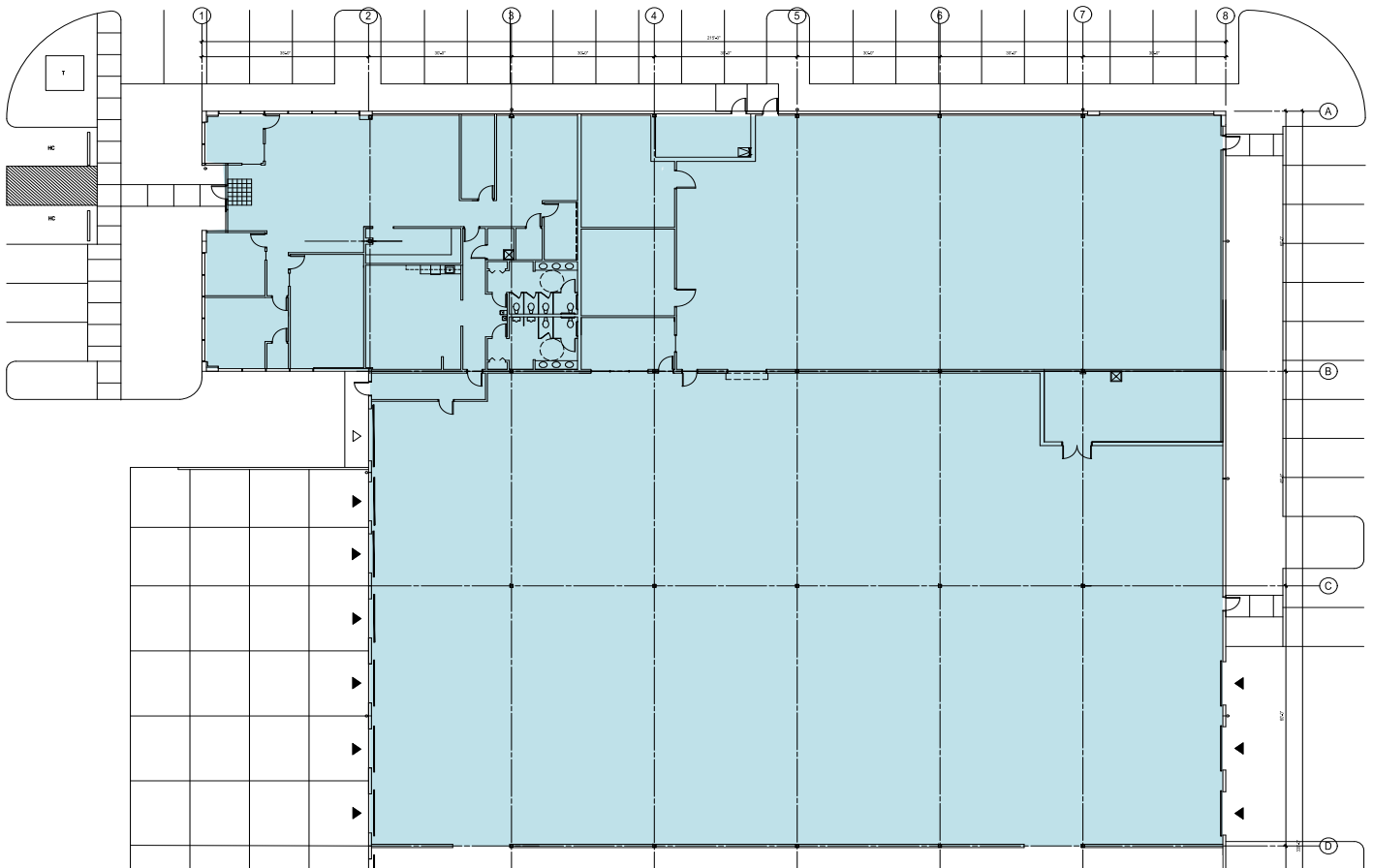

KIDDER.COM

This information supplied herein is from sources we deem reliable. It is provided without any representation, warranty, or guarantee, expressed or implied as to its accuracy. Prospective Buyer or Tenant should conduct an independent investigation and verification of all matters deemed to be material, including, but not limited to, statements of income and expenses. Consult your attorney, accountant, or other professional advisor.

